

SV Solenoid Directional Valve (20MPa)

It is used in electric terminal lubrication system. Electric control box receives signal from the PV-2E pressure control valve and controls the valve to realize alternating supply and opening of two main lines. Cylindrical slide valve structure is adopted to make valve port open and close tightly and maintain high pressure without leakage. The strong electromagnet and spring buffer make the switching reliable.



Specification

Model	Way	Voltage	Pressure	Flow	Return port	Switching	Ambient	Spring type	N.W
SV-23B	3	220V	20 MPa	3L/min	10MPa	30cycle/min	0~50℃	Compensation	10kg
SV-23D	3	24V							10kg
SV-24B	4	220V							17kg
SV-24D	4	24V							17kg

Instructions

Compatible lubricants: 310~385 (NLG1 0#~1#)
When the reservoir pressure (return oil port pressure) is below 3MPa, it can be used directly. When it is 3~10MPa, external oil drain method is required.

Parameters

Power supply	AC220V 50HZ
Power	30W
Current	0.6A
Instantaneous current	6.5A
Voltage fluctuation	+10~-5%
Relative humidity	0~95%
Duty cycle	100%
Insulation level	H

Dimension

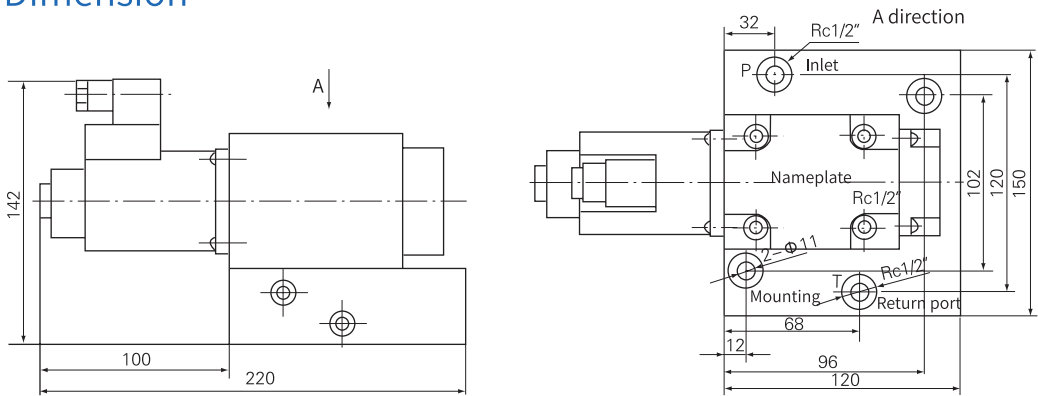

SV-23 2-position 3-way directional valve

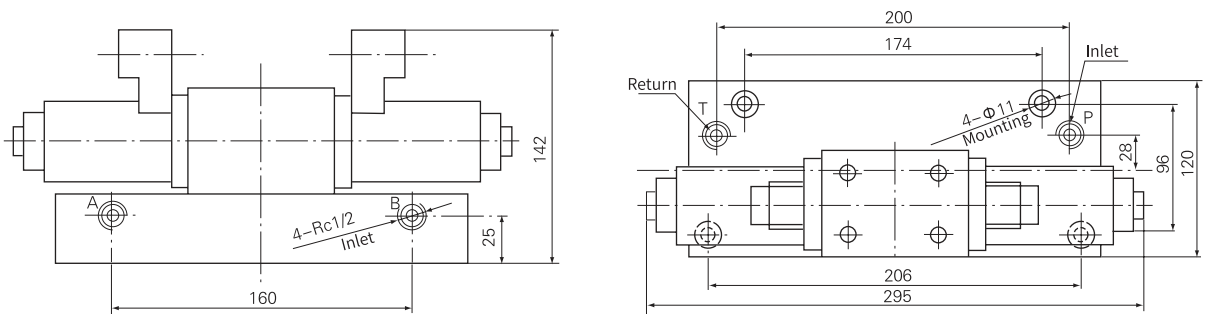

SV-34 3-position 4-way directional valve