

VSL-KR Dual-line Distributor (40MPa)

There are outlets on both the top and bottom of the VSL-KR, and when the distributor piston moves forward and backward, grease is discharged from the outlets on both sides. There is a combined discharge structure in the corresponding upper and lower outlets. To change the odd number of outlets, simply unscrew the screws in the holes. The operation of the distributor can also be directly observed from the action of the indicator rod, and the discharge of each outlet can be adjusted by adjusting the screws. This type of distributor is used under the alternating supply pressure of two main supply pipes, and the piston action is directly controlled by the supply pressure.



Specification

Model	Pressure	Working pressure	Rated discharge	Turn 1 circle screw
VSL-KR	40 MPa	≤ 1.0 MPa	0 ~ 5 mL/cyc	0.15 mL

lubricant: Ggrease 265(25°C, 150g)1/10mm(NLGI 0#~2#) or Oil > N68, if it is oil, please use it under 20MPa.

Operating environment temperature is -10 °C ~ 80 °C

Dimension

Model	VSL2-KR	VSL4-KR	VSL6-KR	VSL8-KR
Outlets	2	4	6	8
L(mm)	44.5	76	108	140
N.W(kg)	1.5	2.5	3.5	4.5

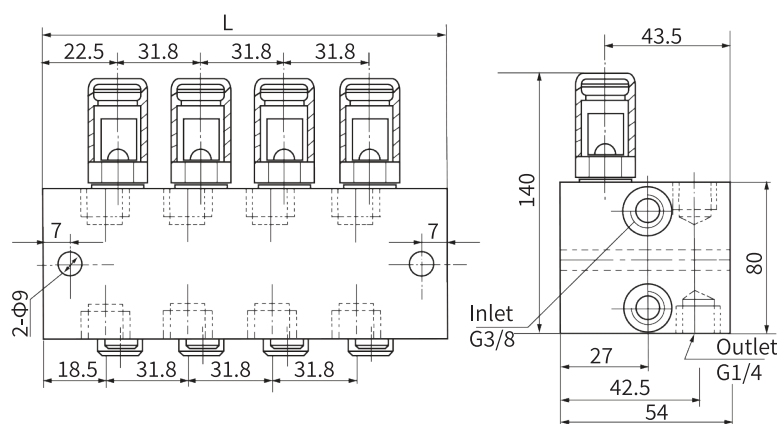

Order Code

VSL 8 KR F

- F = Viton seal, N = NBR rubber seal
- KR = With adjustment device
- Number of outlets = 2 ~ 8

Instructions

If it is necessary to merge the corresponding upper and lower outlets, simply unscrew the pressure plug in the upper oil outlet hole with a 6mm hex wrench, remove the oil distribution sleeve through hole and install it downwards, then tighten the pressure plug, the upper outlet is blocked with a G14 plug to prevent dust. Distributors used outside the range of -10 °C to 80 °C must be specified in the purchase in order to provide low and high temperature resistant oil seals during supply.