

## JHGS2 Progressive Pump(Cartridge)

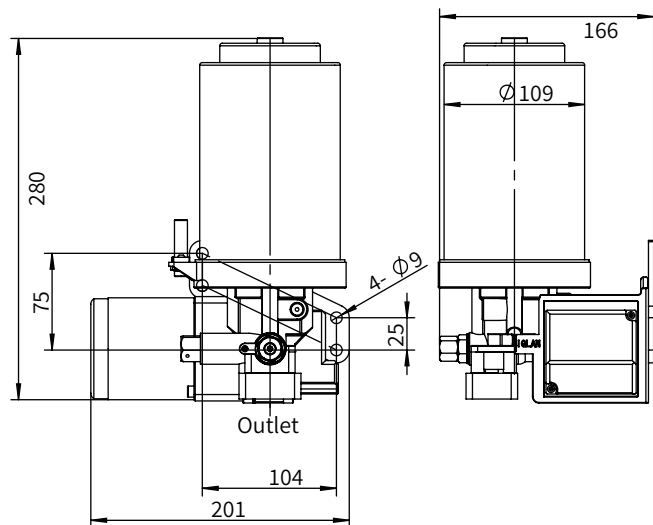

### Feature

1. Lubrication and interval time are controlled by PLC.
2. Low level detector can be installed to detect oil level and automatically send out signal.
3. For lubricants NLGI 000, 00, 0, 1#.
4. It needs to be used with a standard 700mL cartridge, which needs to be purchased separately.

### Specification

Model	JHGS2
Motor power	25 W
Lube time	PLC
Interval time	PLC
Pressure	8.0 MPa
Discharge	15 mL/min
Outlet dia.	Φ6 or Φ8
Reservoir	1500mL

### Wiring

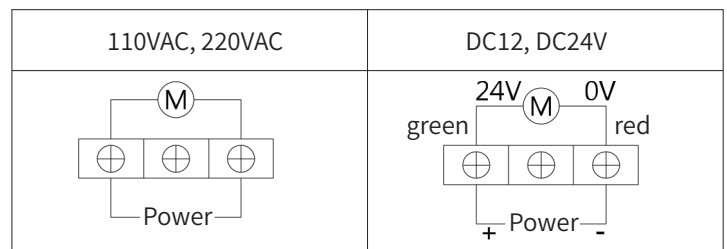

### Order Code

<b>JHGS2</b>	<input type="checkbox"/>	<input type="checkbox"/>	<input type="checkbox"/>	<input type="checkbox"/>
	Cartridge	Voltage	Outlet fittings	Low level switch
	7 = 700mL	A = 110VAC B = 220VAC C = 12VDC	D6 = Φ6 straight D8 = Φ8 straight H6 = Φ6 elbow H8 = Φ8 elbow	1 = N.O. contact 0 = without

### Accessories

