

MG2 Metering Valve



MG2-20

MG2C-20

Specification

Model	Output(mL/CY)	Mark	L(mm)	Fittings	Working	Reset
MG2-3	0.03	3	48	Sleeve type	≥2.5MPa	≤1.4MPa
MG2-5	0.05	5	48			
MG2-13	0.13	13	48			
MG2-20	0.20	20	64			
MG2-30	0.30	30	64			
MG2-50	0.50	50	64			
MG2C-3	0.03	3	53.5	Quick type		
MG2C-5	0.05	5	53.5			
MG2C-10	0.10	10	53.5			
MG2C-20	0.20	20	69.5			
MG2C-30	0.30	30	69.5			
MG2C-50	0.50	50	69.5			

Order Code

MG2	5
Fitting Type	Output
MG2 = Sleeve type	3 = 0.03mL/cyc
MG2C = Quick type	5 = 0.05mL/cyc
	13 = 0.13mL/cyc
	20 = 0.20mL/cyc
	30 = 0.30mL/cyc
	50 = 0.50mL/cyc

Dimension

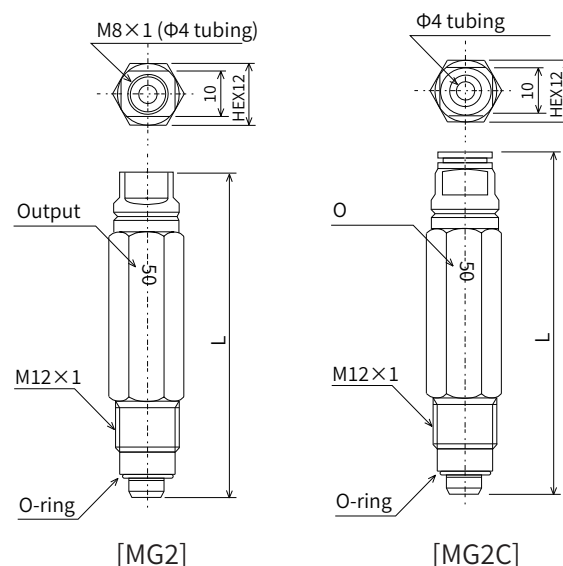

[MG2]

[MG2C]

Features

1. Pressurized quantitative metering valve, a direct pressure action type.
The pressure oil delivered by the pump pushes the piston built into the metering valve to move, forcing the quantitative lubricant to be discharged.
When the pump stops working, the piston of the metering part is reset under the action of the spring force, that is, the quantitative lubricant is stored.
2. Accurate discharge, the metering part is discharged only once in one cycle, and the distance between each other in the system, whether it is far, near, high or low, horizontal or vertical installation, has no effect on the discharge.
3. Forced discharge, sensitive action. Two seals are used to prevent the discharged from flowing back.
4. Metering valves can be selected based on the needs of each lubrication point, and can be used in combination with the MG2J junction, either in series or parallel.
5. Sleeve type: $\Phi 4$ nylon tube needs to be combined with PA4 compression bushing and PB4 sleeve. Quick plug-in type: $\Phi 4$ nylon tube can be inserted.
6. Applicable to NLGI 000#, 00#, 0#, 1# and 2# grease.

Metering Junction($\Phi 6$, $\Phi 8$)

Order Code

MG2J — **5** — **R**

Outlets 2-12 Thread on both sides
 M = M10x1(with PD-601)
 R = Rc1/8

Specification

Model	Oulets	L1	L2	N.W(g)
MG2J-1R	1	33	22	22
MG2J-2R	2	49	38	34
MG2J-3R	3	65	54	46
MG2J-4R	4	81	70	58
MG2J-5R	5	97	86	70
MG2J-6R	6	113	102	81
MG2J-7R	7	129	118	94
MG2J-8R	8	145	134	106
MG2J-9R	9	161	150	118
MG2J-10R	10	177	166	130
MG2J-12R	12	209	198	142

Dimension

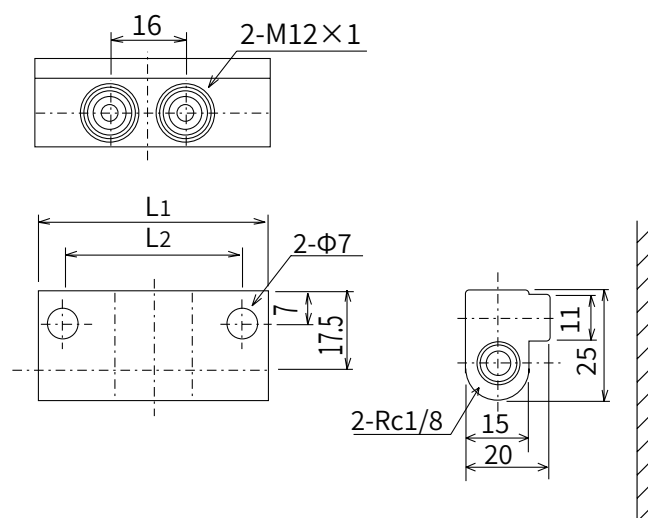

Made of aluminum alloy, with anodized surface, beautiful appearance. The mounting holes can be processed as needed.

Assembly Code

MG2K 5 1 2 3 4 5 A D6 G

— Junction right side: N = None/Rc1/8, G = Plug, D6 = $\Phi 6$ straight connector, D8 = $\Phi 6$ straight connector, H6 = $\Phi 6$ elbow, H8 = $\Phi 8$ elbow

— Junction left side: N = None/Rc1/8, G = Plug, D6 = $\Phi 6$ straight connector, D8 = $\Phi 6$ straight connector, H6 = $\Phi 6$ elbow, H8 = $\Phi 8$ elbow

— A = Sleeve type valve fittings, C = Quick type valve fittings

— Discharge of each metering valve

— Number of outlets 2~12

— MG2+MG2J

