

VSKV-KR Dual-line Distributor (40MPa)

Feature

The front of VSKV-KR dual line distributor is equipped with upper and lower discharge ports. When the distributor piston moves in both directions, grease is discharged from the upper and lower ports respectively. The working condition of the distributor can also be directly observed from the action of the indicator rod, outlet flow rate can be adjusted within the specified range by adjusting the screw. VSKV-KR is suitable for a 40 MPa dual line grease centralized lubrication system. Under the alternating pressure of two main lines, it controls the piston to move and discharge, and distributes lubricant quantitatively to lubrication points.

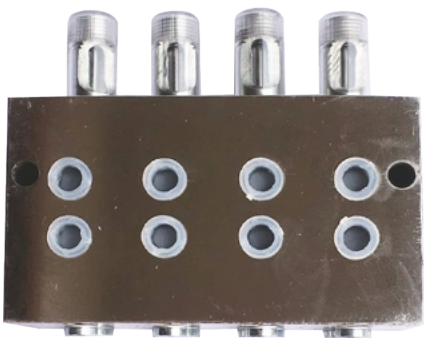

Specification

Model	Nominal pressure	Action pressure	Rated output	Adjusting screw
VSKV-KR	40 MPa	≤1.5MPa	0 ~ 1.5mL/cyc	0.05mL/circle

Compatible with NLGI 0 #~2 # greases or oils with viscosity grades greater than N68, with an operating temperature range of -10 °C~80 °C. If using oil as the medium, please use it under a pressure of 20MPa.

Dimension

Model	VSKV2-KR	VSKV4-KR	VSKV6-KR	VSKV8-KR
L1	52	80	108	136
L2	36	64	92	120
N.W kg	1.5	2.0	2.7	3.3

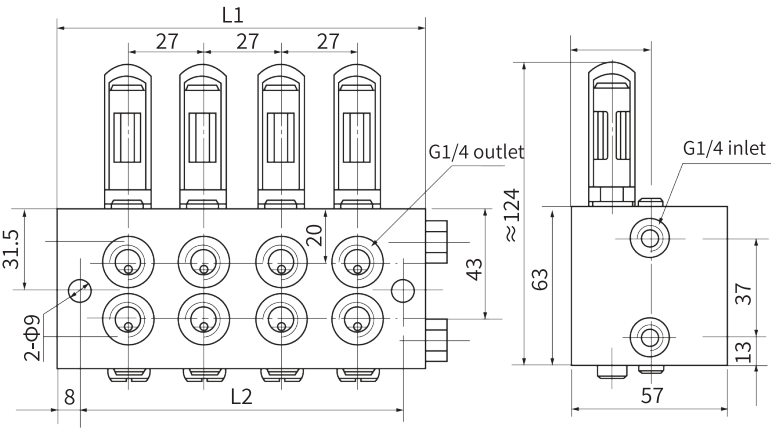

Order Code

VSKV

8

KR

F

F = Fluororubber seal, N = NBR rubber seal

KR = With pointer adjustment device

Number of outlets 2~8

Note

Distributors installed and used in environments with temperatures outside the range of -10 °C to 80 °C must be specified before ordering in order to provide low and high temperature resistant oil seals.